



Informatica® Cloud Application Integration  
January 2020

# Tutorial: Hello World

Informatica Cloud Application Integration Tutorial: Hello World  
January 2020  
January 2020

© Copyright Informatica LLC 1993, 2020

Publication Date: 2020-01-14

# Table of Contents

<b>Preface</b> .....	<b>4</b>
<b>Chapter 1: Introduction</b> .....	<b>5</b>
Before you Begin. ....	5
Assets and Concepts. ....	5
Tutorial Objectives . ....	6
<b>Chapter 2: Process One: Print "Hello World"</b> .....	<b>7</b>
Step 1: Create a Process. ....	7
Step 2: Configure Basic Process Properties. ....	8
Step 3: Configure the Output. ....	8
Step 4: Save and Publish the Process. ....	9
Step 5: Invoke the Process. ....	10
Step 6: View the Invoked Process on Application Integration Console. ....	11
<b>Chapter 3: Process Two: Print Input Message</b> .....	<b>12</b>
Step 1: Create a Process. ....	12
Step 2: Configure Basic Process Properties. ....	13
Step 3: Configure Output. ....	13
Step 4: Save and Publish the Process. ....	14
Step 5: Invoke the Process. ....	15
Step 6: View the Invoked Process on Application Integration Console . ....	16

# Preface

This module is a tutorial about simple process creation.

# CHAPTER 1

## Introduction

In the *Hello World* tutorial, you use basic Application Integration features to create the following processes:

- A process that returns the output "Hello World."
- A process that returns output based on what you enter as text input.

## Before you Begin

Before you begin, perform the following tasks:

1. Create an Informatica Intelligent Cloud Services account and verify that you have access to the Application Integration and the Application Integration Console services. For information on how to create an account, see the *Register* section of the [Training Program Overview](#) community article.
2. Log in to Application Integration, go to the **Explore** page and select **Projects** in the Explore list.
3. Create a **Tutorial** project. Click **New Project** to create the project.
4. Inside **Tutorials**, create a **Hello World** folder. Click **New Folder** to create the folder.

## Assets and Concepts

You learn about processes, how to publish and invoke processes, and about the Application Integration Console.

You use the following assets, concepts, and services:

### Assets

#### Process

A process is a set of instructions that automate a business requirement. Use process steps to configure a process to run tasks in parallel, obtain information using complex XQuery, take decisions based on some criteria, and much more.

### Concepts

#### Publish

Publish a process to make it available to all users who have access.

### **Invoke**

Invoke a process to initiate the process. The steps in the process run one after the other.

### **Services**

#### **Application Integration Console**

Application Integration Console is an Informatica Intelligent Cloud Services service that you can use to perform detailed monitoring and debugging for invoked process instances.

## Tutorial Objectives

After you complete this tutorial, you will be able to perform the following tasks:

- Create a process that returns fixed text as output.
- Create a process that accepts text as input and returns the text as output.
- Publish and invoke the processes.
- View the invoked processes on the Application Integration Console.

## CHAPTER 2

# Process One: Print "Hello World"

In this section, you create a simple process with a fixed output, "Hello World."

## Step 1: Create a Process

1. In Application Integration, click **New**.
2. In the **New Asset** dialog box, select **Processes** > **Process** and then click **Create**.

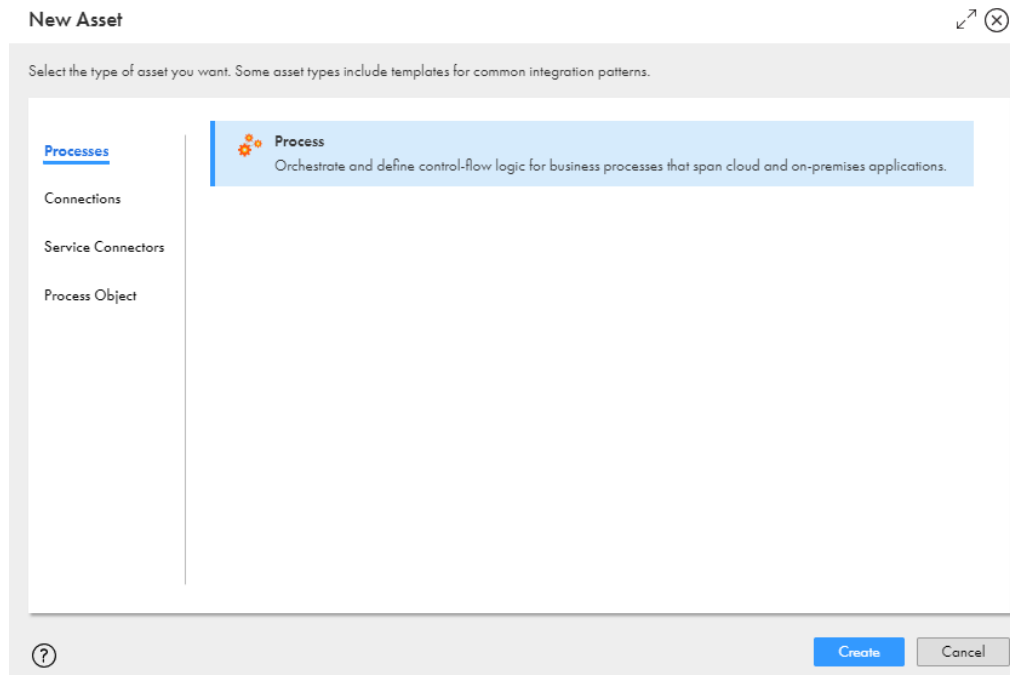

A process template opens.

## Step 2: Configure Basic Process Properties

Use the **Start** step to configure basic process properties.

1. Click the **Start** step.  
The process properties section appears.
2. Select the **General** tab and enter the following properties:
  - a. In the **Name** field, enter **Print Hello World**.
  - b. Click **Select** next to **Location** and then browse to and select the **Tutorials > Hello World** folder.
  - c. In the **Description** field, enter **Accepts an HTTP request, sets a static payload on the message, and then returns a response**.
3. Select the **Start** tab and enter the following properties:
  - a. In the **Binding** list, select **HTTP/SOAP**.  
The Binding property defines how a process is invoked.
  - b. Select **Allow anonymous access**.  
Anonymous access ensures that all users can access process service URL and invoke the process.
  - c. In the **Run On** list, select **Cloud Server**.  
The process runs on the Cloud Server and not on a Secure Agent.

Note: Do not modify the **Run As**, **Allowed Roles**, or **Applies To** fields in the **Start** tab.
4. Select the **Output Fields** tab and add an output field. In the **Name** field, enter **Message**, and in the **Type** field, enter **Text**.

Do not modify the **Input Fields**, **Temp Fields**, **Messages**, **Advanced**, or **Notes** tabs.

## Step 3: Configure the Output

Use an Assignment step to define a static output message, "Hello World".

1. Drag an **Assignment** step from the palette on to the canvas in between the **Start** and **End** steps.
2. Select the **Assignment** step.  
The step properties section appears.
3. Click the **General** tab and enter **Set Output Message** in the **Name** field.
4. Click the **Assignment** tab and add the field **Message** with value **Content > Hello World**.

**Note:** You can select the **Message** field because you defined it as an output field in *Step 2: Configure Basic Process Properties*.



Print Hello World | Valid

Design

```
graph LR; Start((Start)) --> SetOutputMessage[Set Output Message]; SetOutputMessage --> End((End));
```

Assignment  
Service  
Subprocess  
Create

Set Output Message Properties

General

Assignments

Target	Value
Message	Content <input type="text" value="Hello World"/> <input type="button" value="(x)"/> <input type="button" value="x"/>

The process is complete. You can now save, publish, and invoke the *Print Hello World* process.

## Step 4: Save and Publish the Process

1. Click **Validation**. If there are no errors, click **Save**.  
If there are errors, fix them and then save the process.
2. Click **Actions > Publish**.

## Step 5: Invoke the Process

Paste the process service URL in a browser to invoke the process.

1. In Application Integration, click **Actions** > **Properties** next to the process.

You can do this from Process Designer or from the **Explore** page.

The **Properties for Print Hello World** window appears.

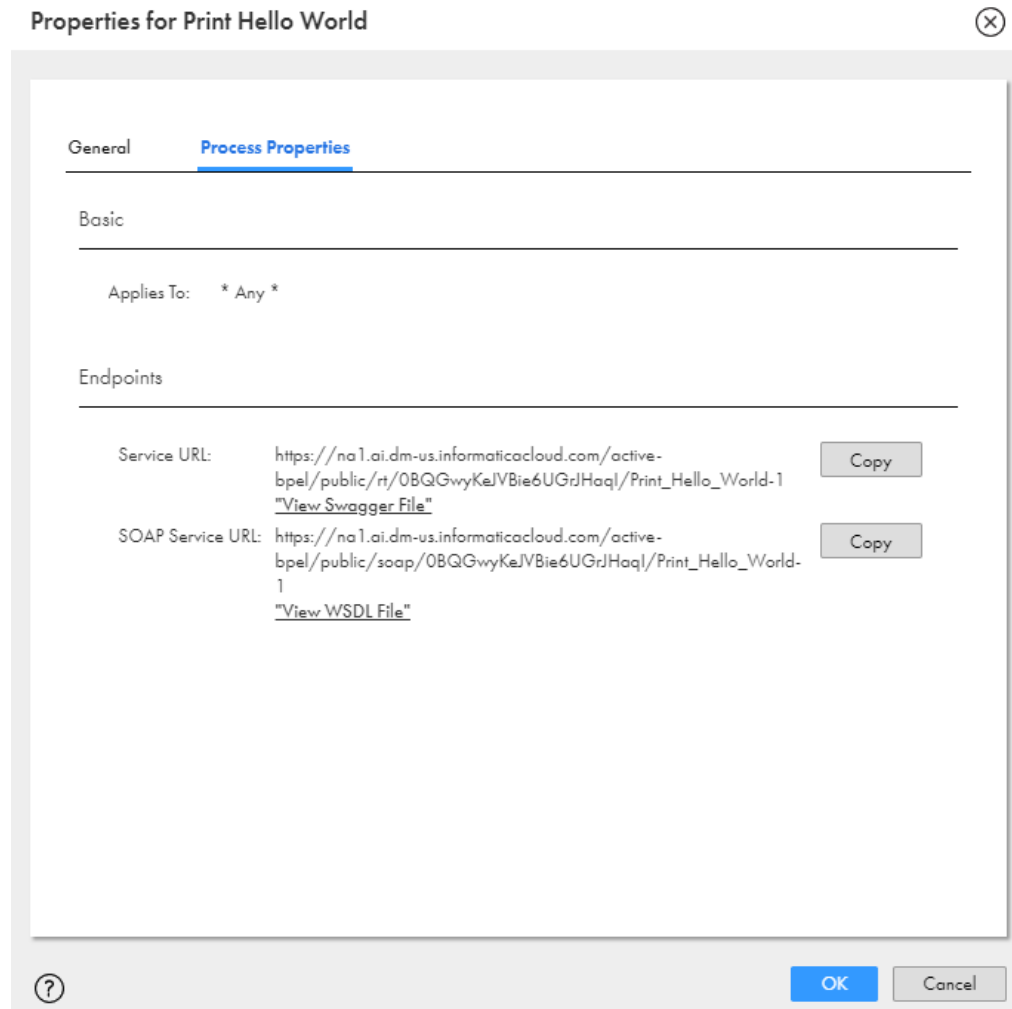

2. Copy the Service URL.
3. Open a browser and paste the service URL in the address bar.

You see the following output:

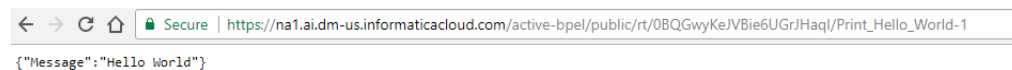

# Step 6: View the Invoked Process on Application Integration Console

1. Select the Application Integration header.  
The **My Services** window opens.
2. Select the Application Integration Console service.
3. The Application Integration Console opens on the **Processes** page.  
You see that the Print Hello World process is in the list of invoked processes and was invoked successfully.

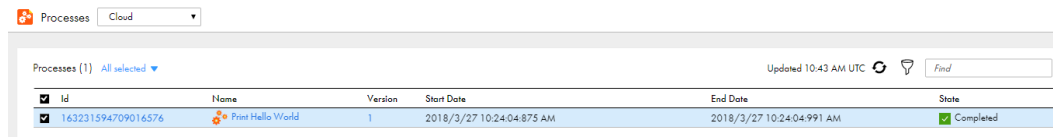

The screenshot shows the 'Processes' page in the Application Integration Console. At the top, there is a header with 'Processes' and a dropdown menu set to 'Cloud'. Below the header, there is a table with the following columns: Id, Name, Version, Start Date, End Date, and State. The table contains one row representing a completed process.

Id	Name	Version	Start Date	End Date	State
163231594709016576	Print Hello World	1	2018/3/27 10:24:04:875 AM	2018/3/27 10:24:04:991 AM	Completed

## CHAPTER 3

# Process Two: Print Input Message

In this section, you create a process that displays output depending on the text you enter when you invoke the process.

## Step 1: Create a Process

1. In Application Integration, click **New**.
2. In the **New Asset** dialog box, select **Processes > Process** and then click **Create**.

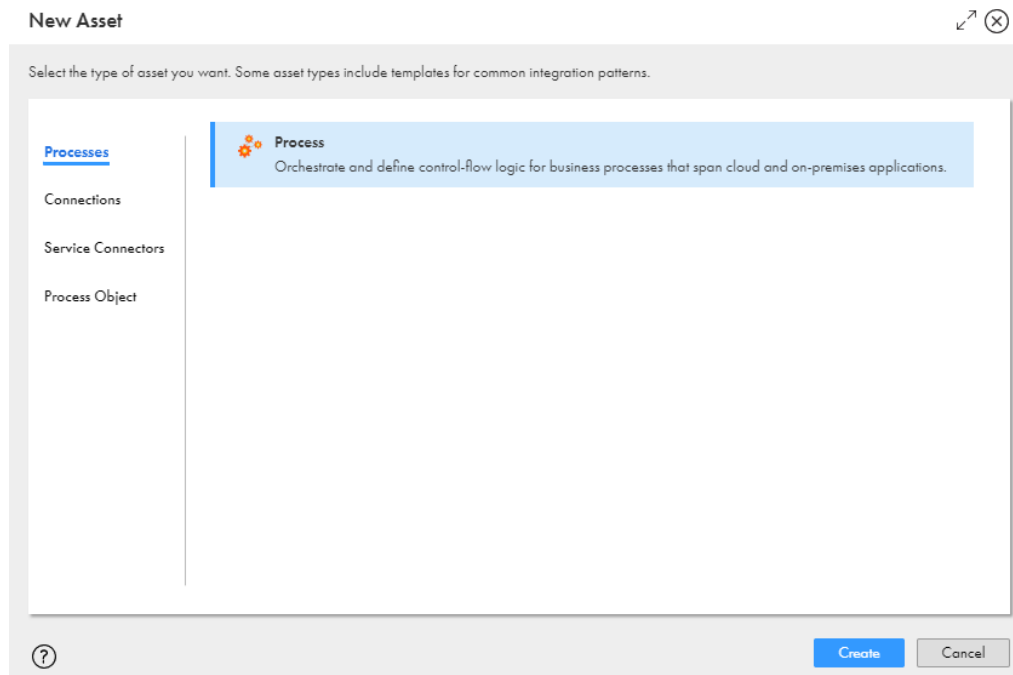

A process template opens.

## Step 2: Configure Basic Process Properties

Use the **Start** step to configure basic process properties.

1. Click the **Start** step.  
The process properties section appears.
2. Select the **General** tab and enter the following properties:
  - a. In the **Name** field, enter **Print Input Message**.
  - b. Click **Select** next to **Location** and then browse to and select the **Tutorials > Hello World** folder.
  - c. In the **Description** field, enter **Accepts an HTTP request with an input message and then returns the input message as the payload**.
3. Select the **Start** tab and enter the following properties:
  - a. In the **Binding** list, select **HTTP/SOAP**.  
The Binding property defines how a process is invoked.
  - b. Select **Allow anonymous access**.  
Anonymous access ensures that all users have access to the process service URL and can invoke the process.
  - c. In the **Run On** list, select **Cloud Server**.  
This process runs only on the Cloud Server and not on a Secure Agent.

Do not change the **Allowed Roles** or **Applies To** fields in the **Start** tab.
4. Select the **Input Fields** tab and add an input field. In the **Name** field, enter **Input** and in the **Type** field, enter **Text**.
5. Select the **Output Fields** tab and add an output field. In the **Name** field, enter **Output** and in the **Type** field, enter **Text**.

Do not change the **Temp Fields**, **Messages**, **Advanced**, or **Notes** tabs.

## Step 3: Configure Output

Use an Assignment step to define values for the output field that you created.

1. Drag an **Assignment** step from the palette on to the canvas in between the **Start** and **End** steps.
2. Select the **Assignment** step.  
The step properties section appears.
3. Click the **General** tab and enter **Configure Output** in the **Name** field.
4. Click the **Assignment** tab and add the field **Output** with value **Field > Input**.  
When you set the value to input, the process takes the input received when you invoke the process and displays it as output.

Print Input Message | Valid

Design

Start → Configure Output → End

Configure Output Properties

Target	Value
Output	Field Input

Add Field Reorder

The process is complete. You can now save, publish, and invoke the *Print Input Message* process.

## Step 4: Save and Publish the Process

1. Click **Validation**. If there are no errors, click **Save**.  
If there are errors, fix them and then save the process.
2. Click **Actions > Publish**.

## Step 5: Invoke the Process

Use a REST client to invoke the process service URL. For example, you can use the Postman REST client.

1. In Application Integration, click **Actions > Properties** next to the process.

You can do this from Process Designer or from the **Explore** page.

The **Properties for Print Input Message** window appears.

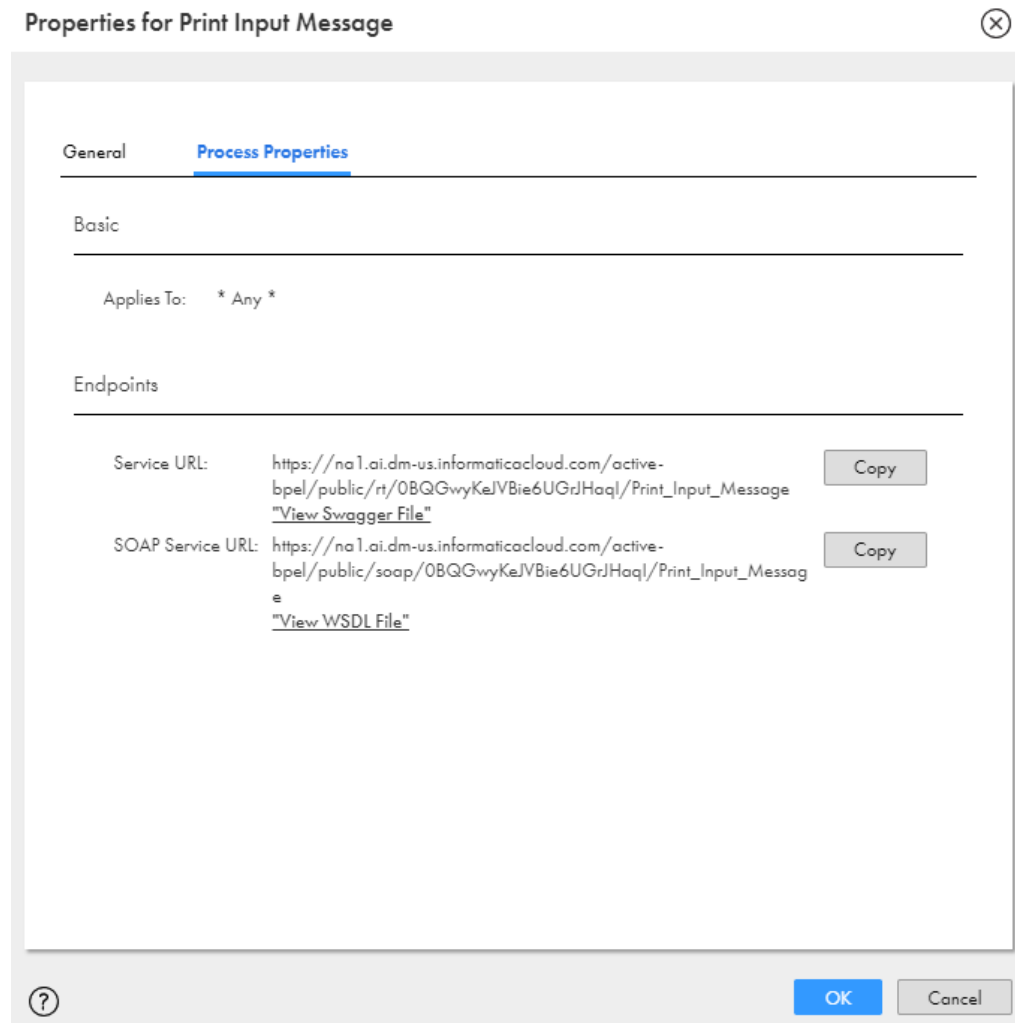

2. Copy the Service URL.
3. Open a REST client.
4. Configure the following properties:
  - a. Change the verb to **POST**.
  - b. Paste the process service URL that you copied in the URL field.
  - c. Set the authorization type to **No Auth**.
  - d. Set the content type to **Application/JSON**.
  - e. Under Body, enter **Input** as a key and **Hello, World. This is my output.** as a value.

5. Click **Send**.

You see the following response: {"Output":"Hello, World. This is my output."}

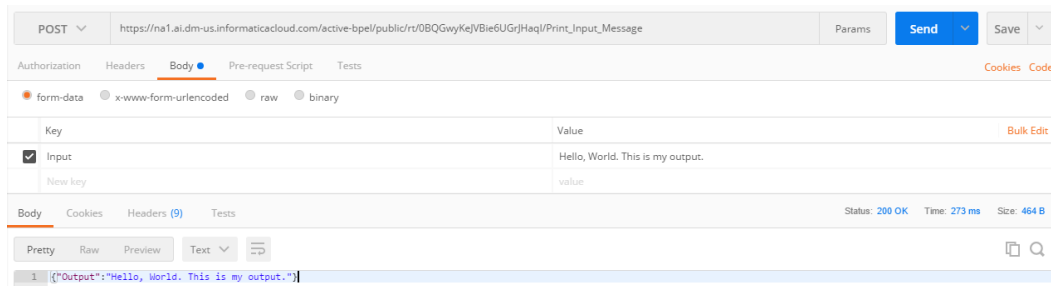

## Step 6: View the Invoked Process on Application Integration Console

1. Select the Application Integration header to open the **My Services** window.
2. Select the Application Integration Console service.
3. The Application Integration Console opens on the **Processes** page.

You see that the Print Input Message process was invoked successfully.

